



PROVINCIA DI CREMONA

COMUNE
DI SONCINO

SCALA DI DISCESA
AL NAVIGLIO
PALLAVICINO

PROGETTO DI RESTAURO
CONSERVATIVO

Bando Regione Lombardia
D.d.u.o. 15 Gennaio 2021 n° 245

PARTICOLARI COSTRUTTIVI 1:20
IMMAGINI VIRTUALI

PROPRIETA':
COMUNE DI SONCINO
IL SINDACO: Dott. Gabriele Gallina

PROGETTISTI E DD.LL:
DOTT. ARCH. MARIO SCARAMUZZA
DOTT. ARCH. VANIA ZUCCHETTI

Crema, 23 Giugno 2021.



IMMAGINE VIRTUALE DELLA NUOVA RINGHIERA DAL NAVIGLIO PALLAVICINO



IMMAGINE VIRTUALE DELLA NUOVA RINGHIERA

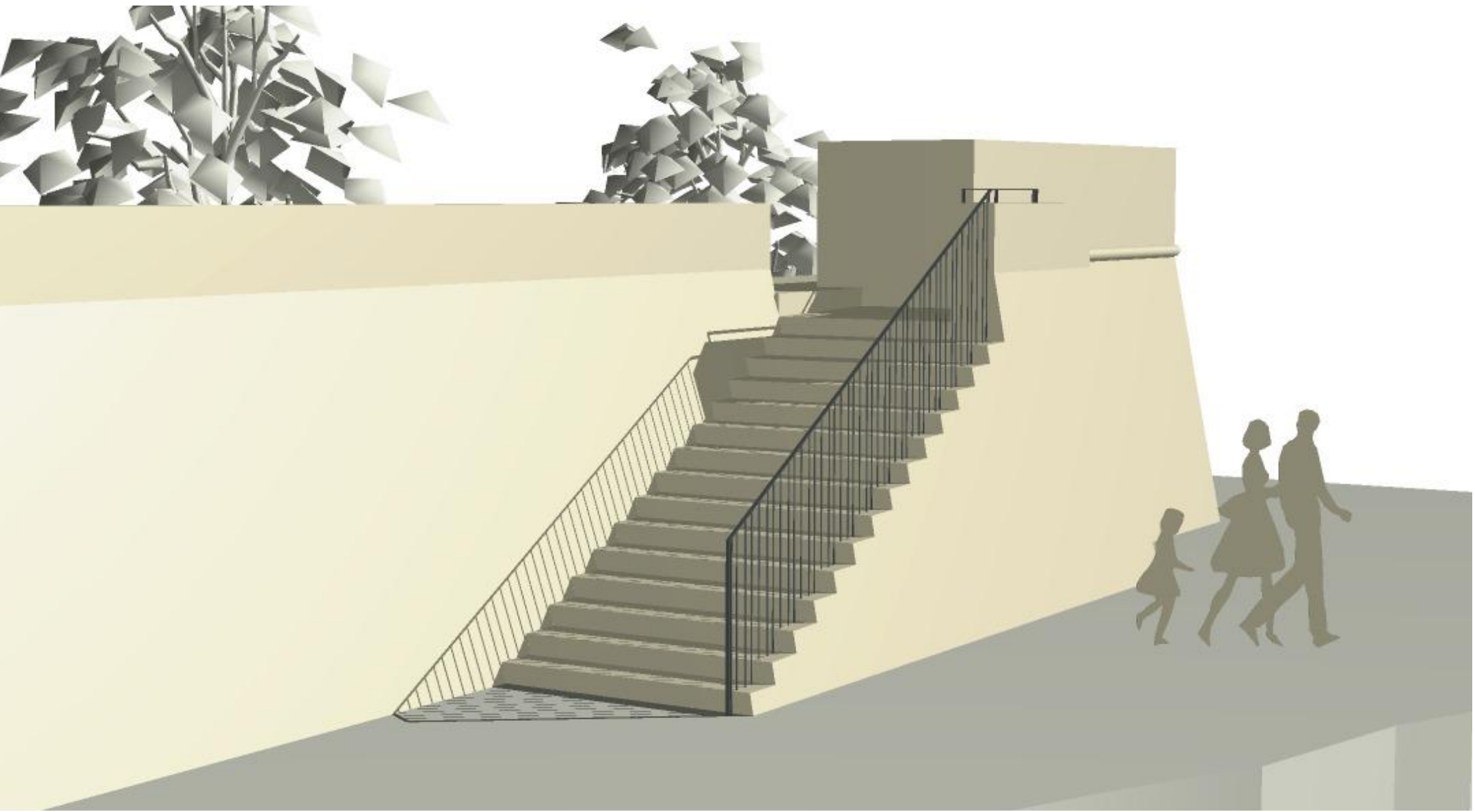
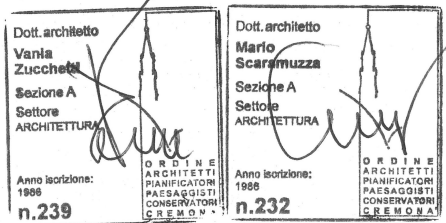

IMMAGINE VIRTUALE DELLA NUOVA RINGHIERA DAL PIANEROTTOLO

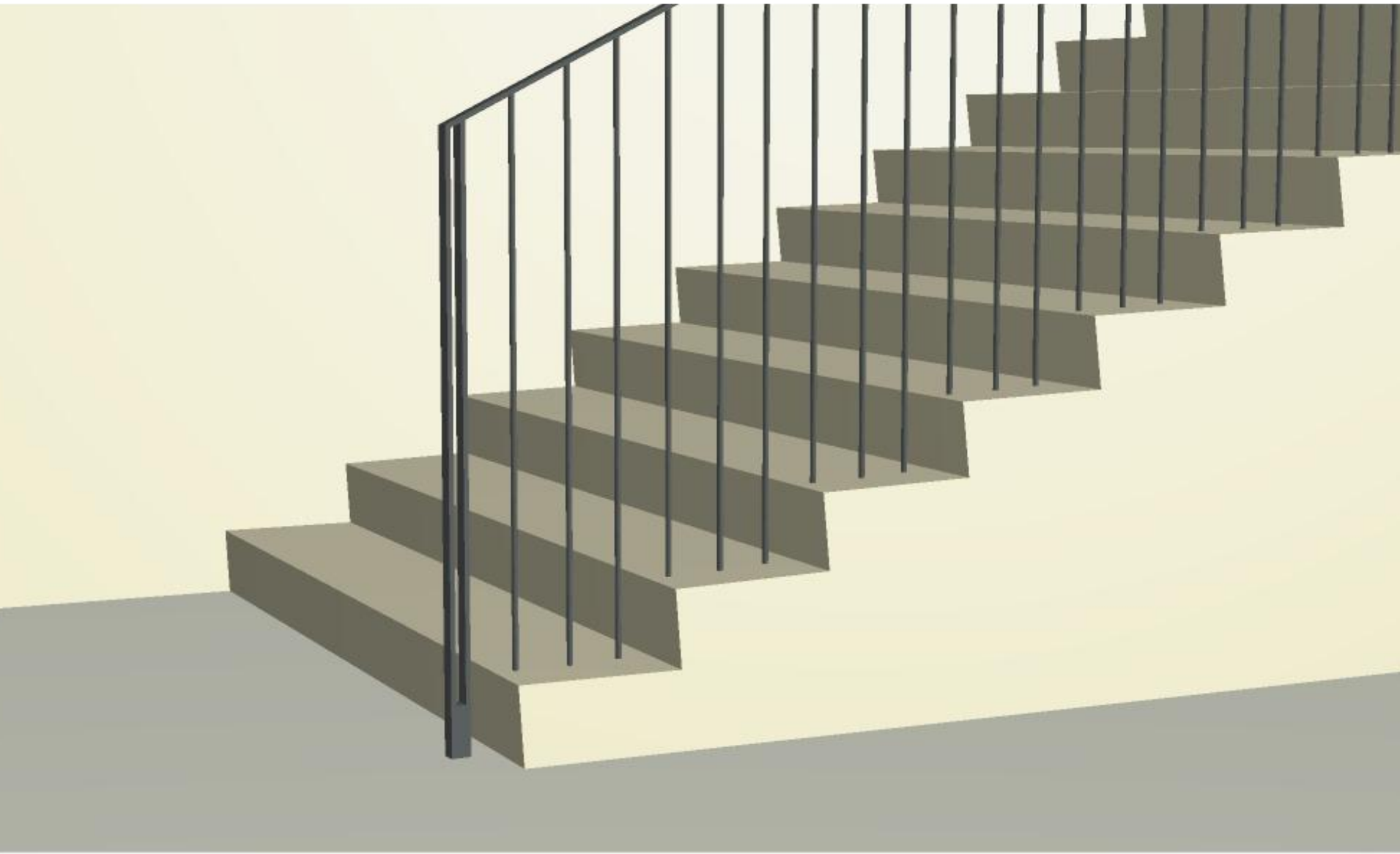

IMMAGINE VIRTUALE DELLA NUOVA RINGHIERA

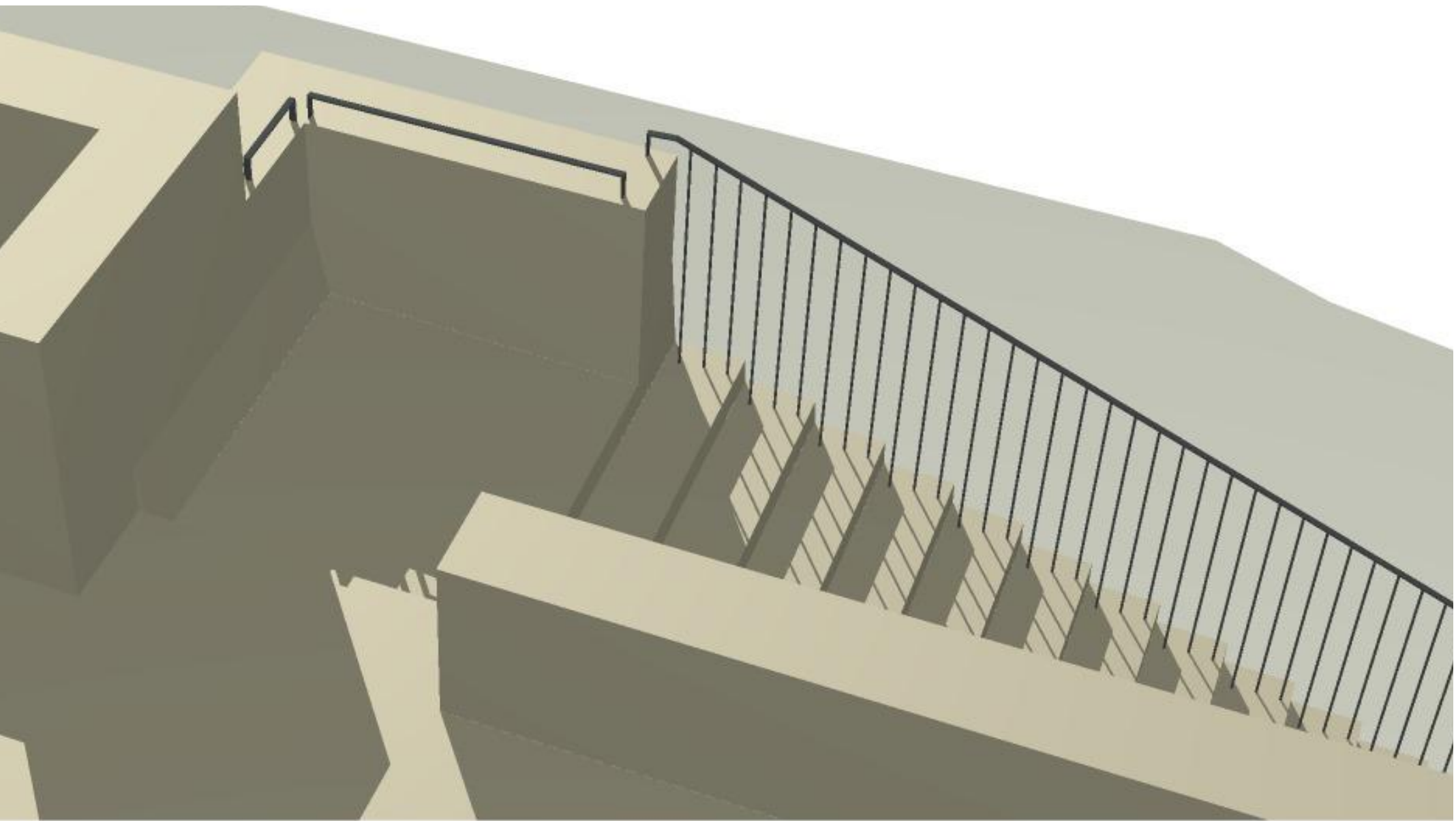
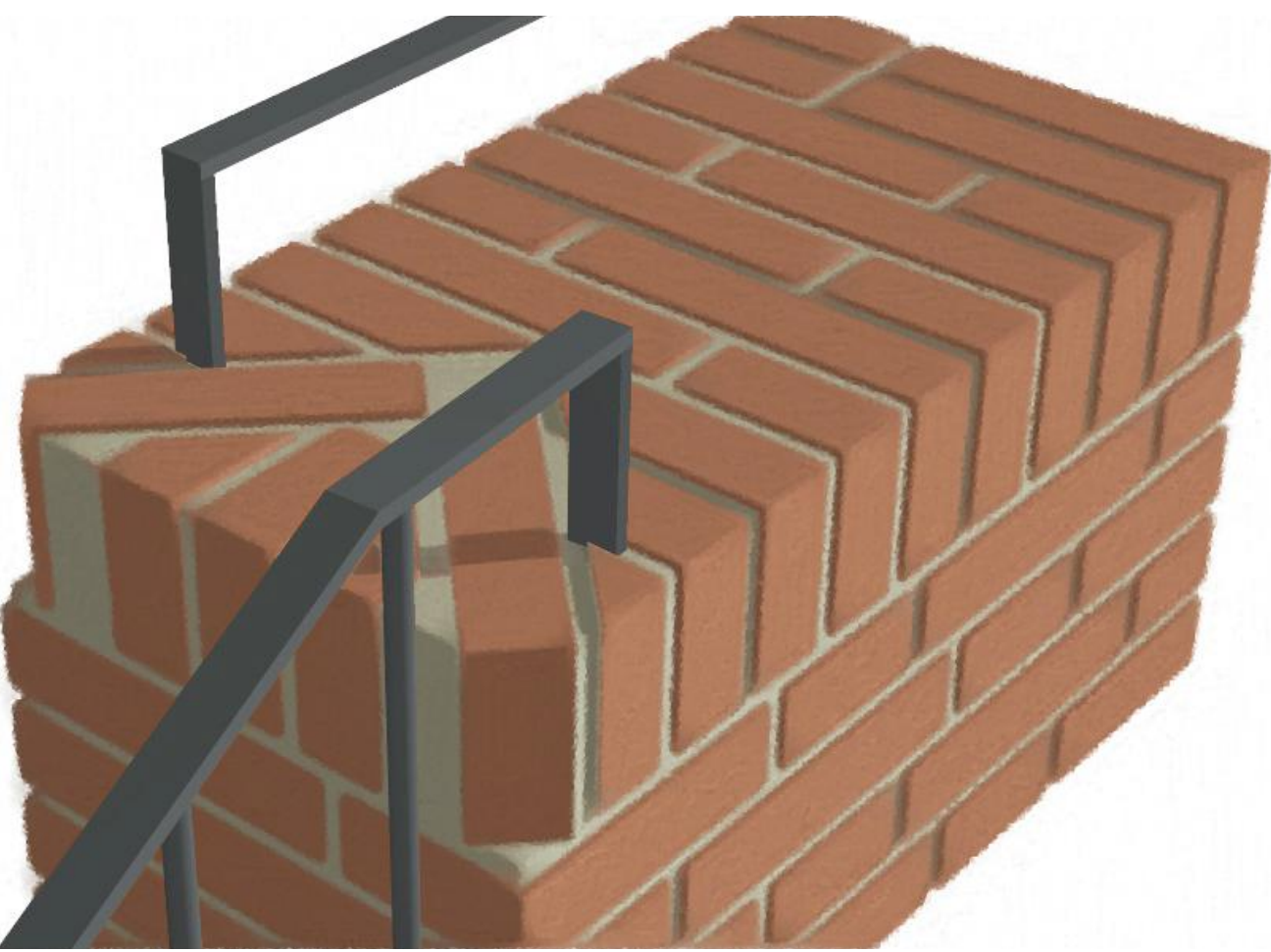
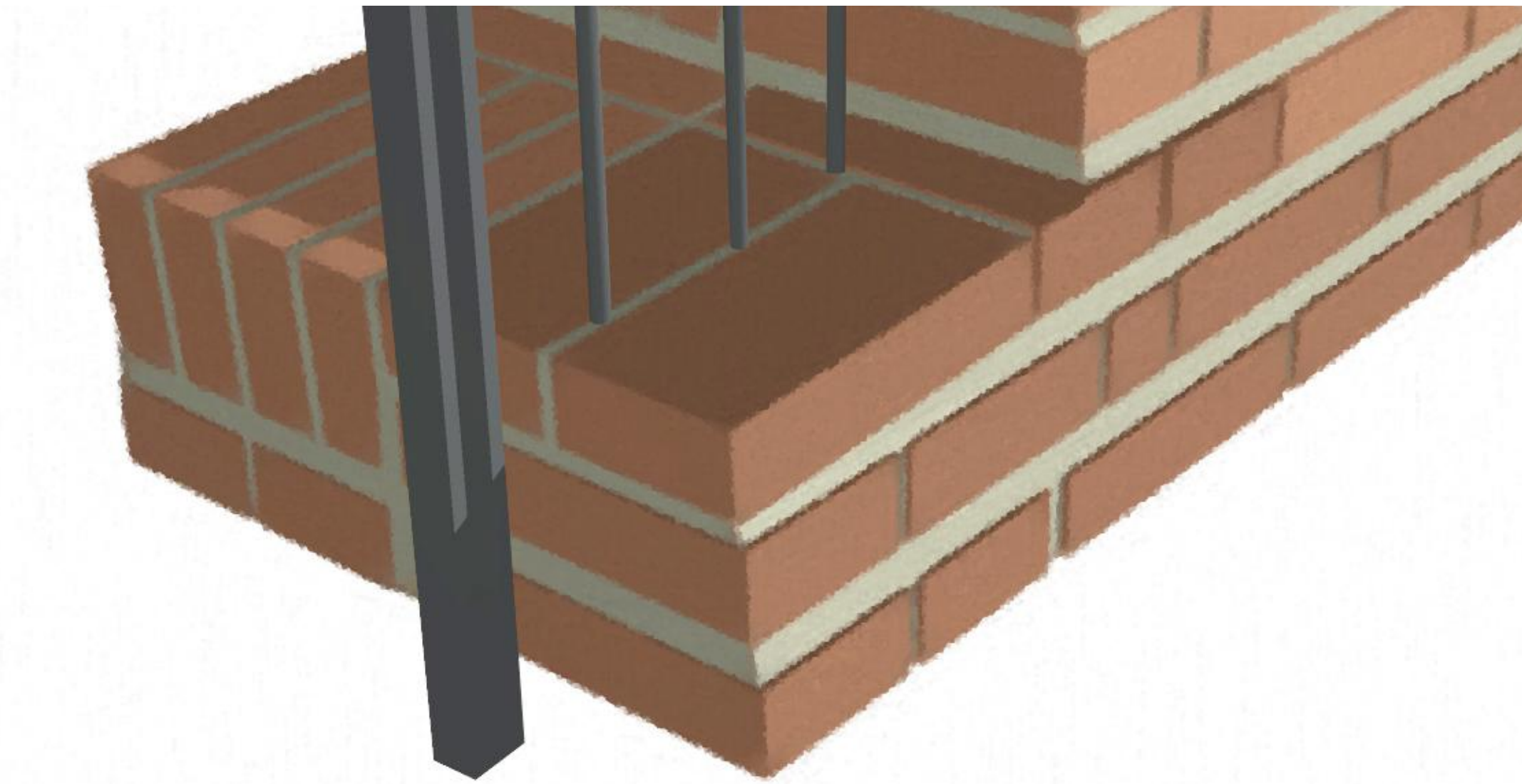
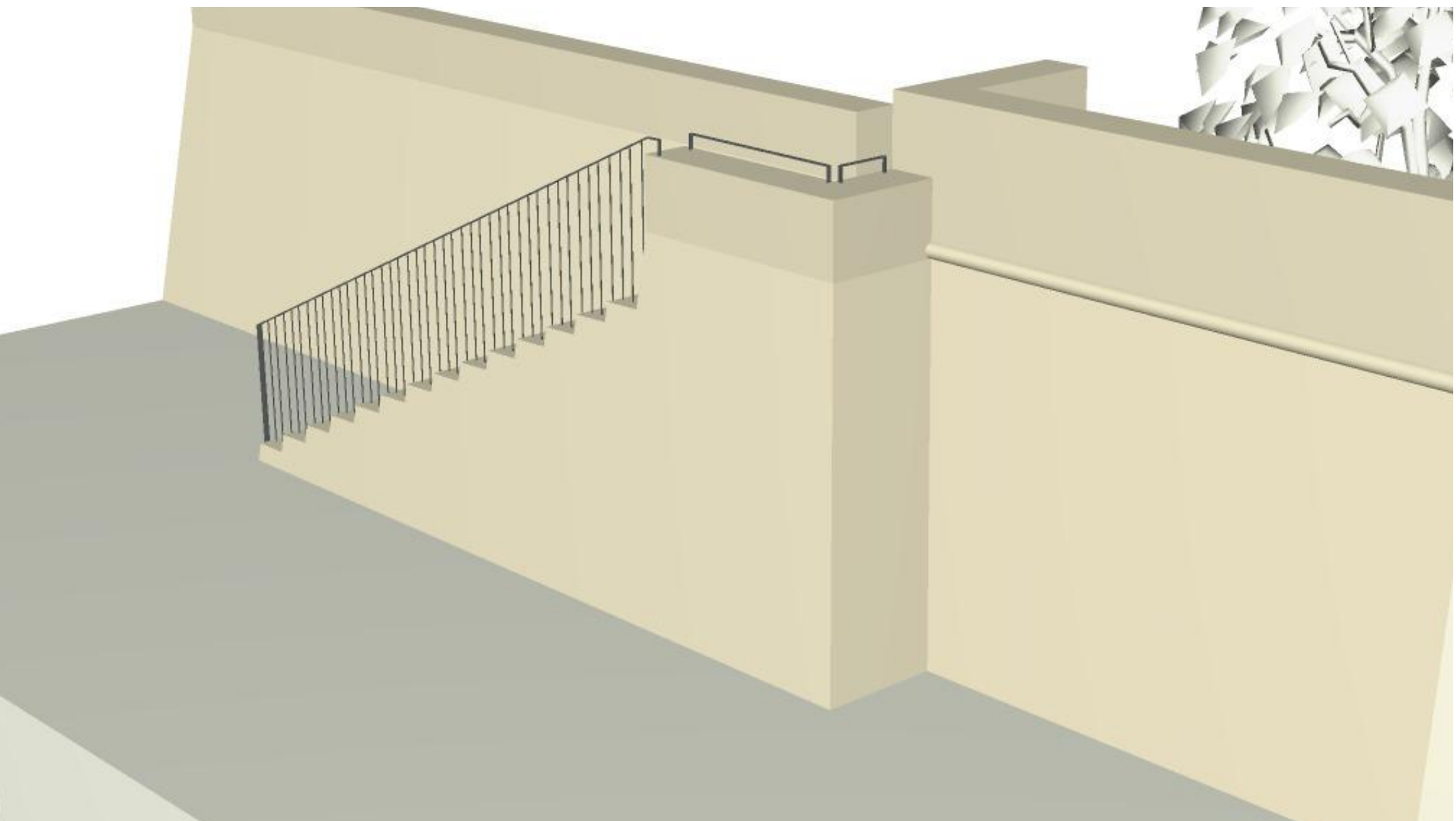
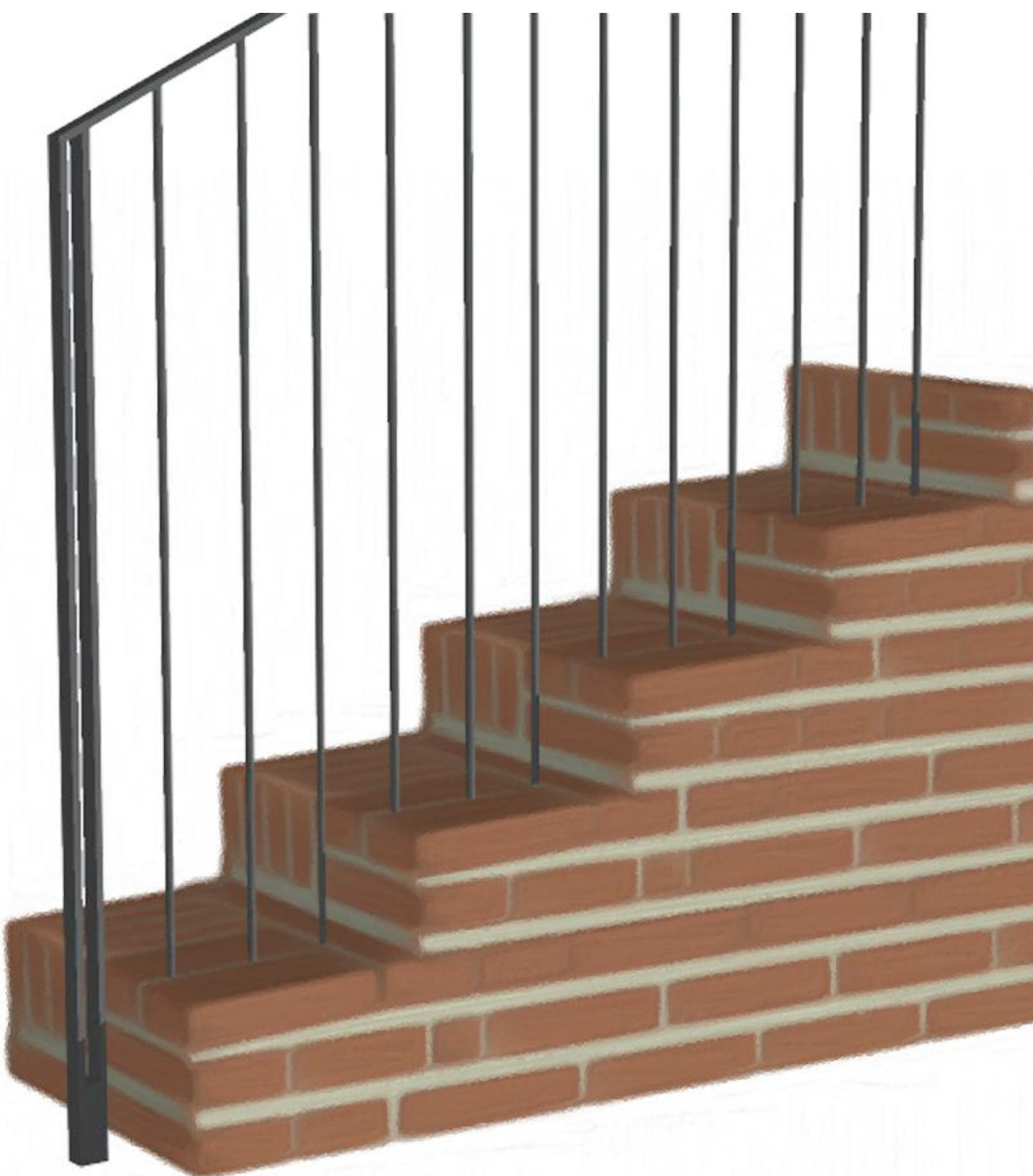
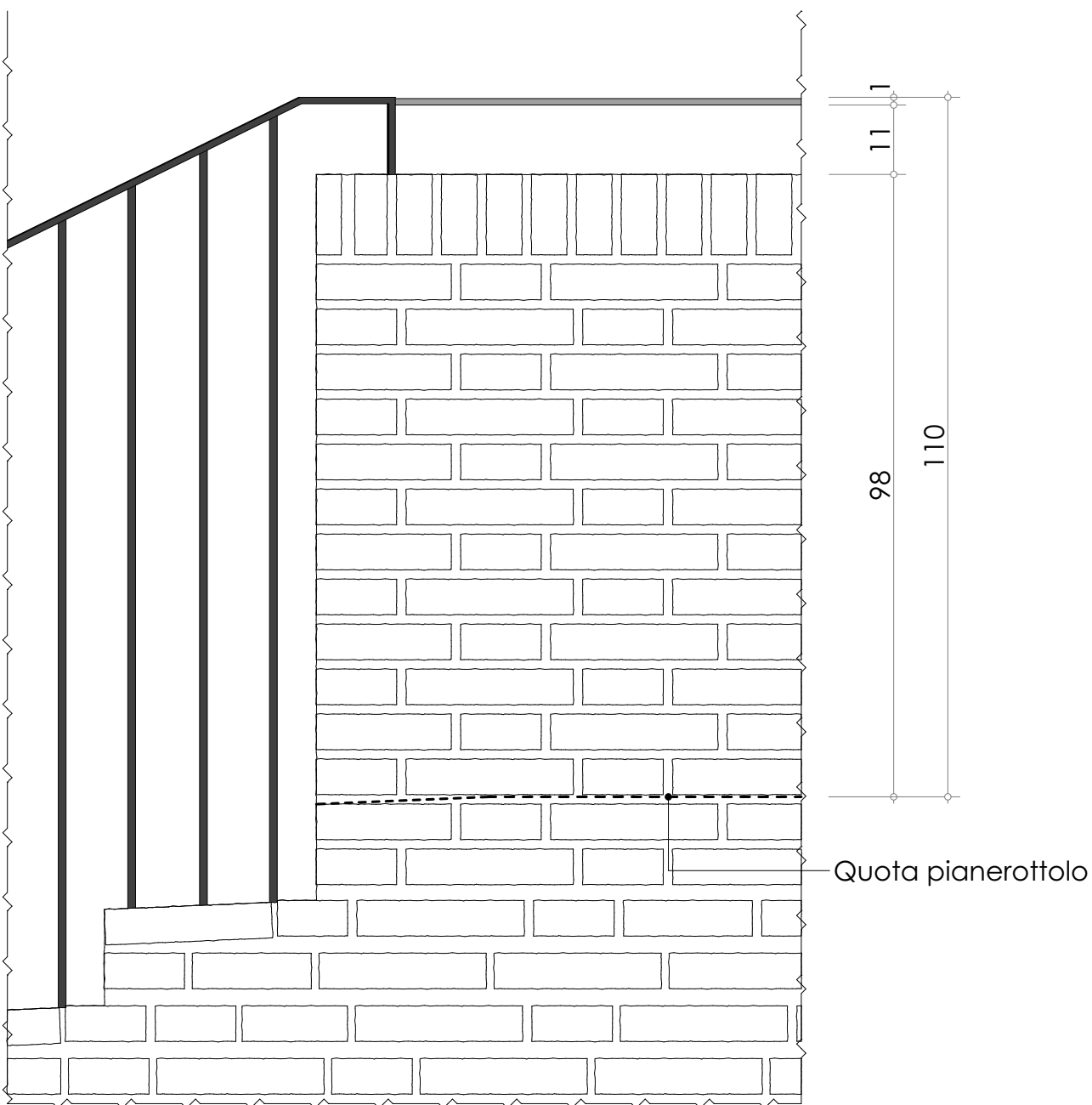
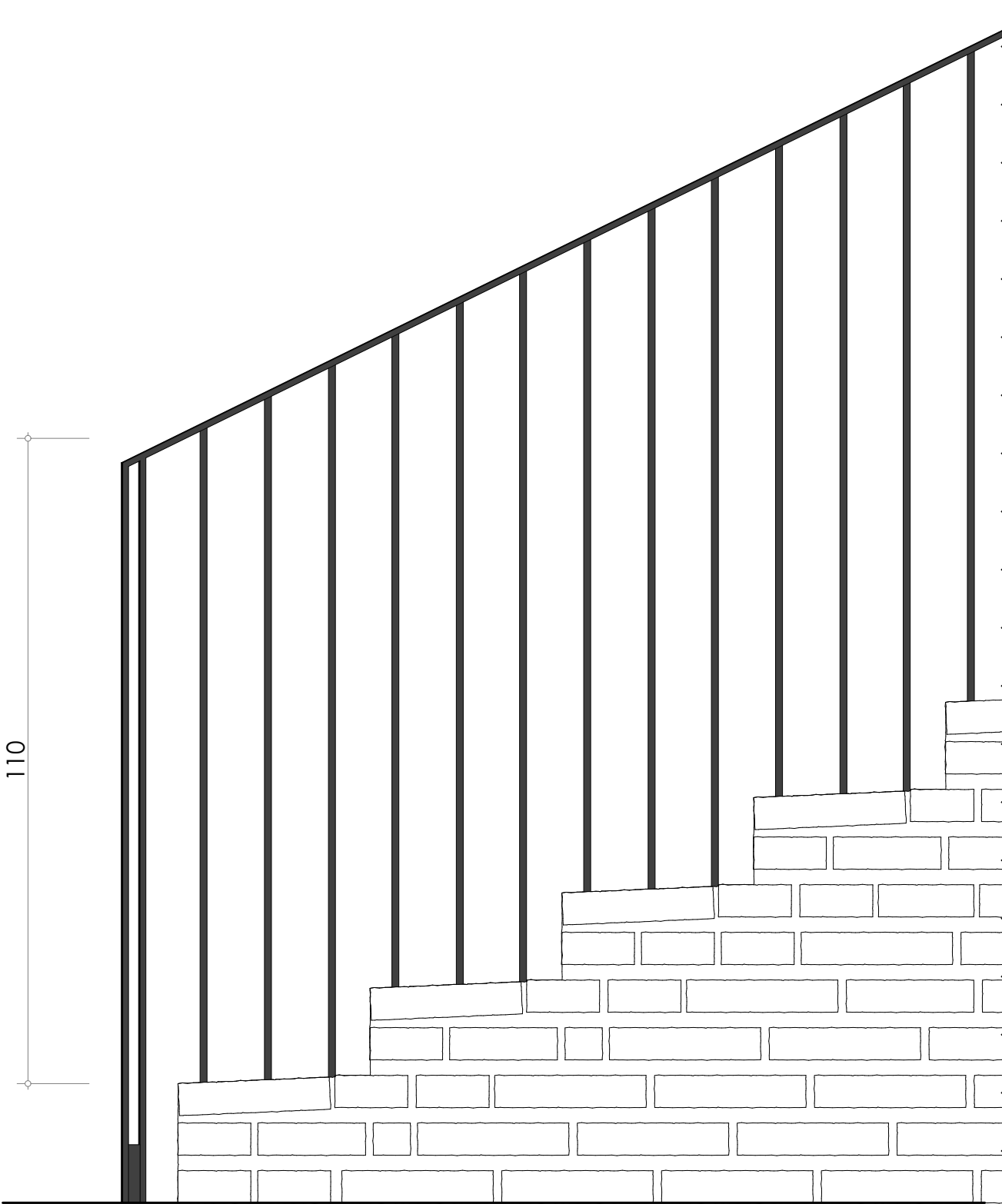
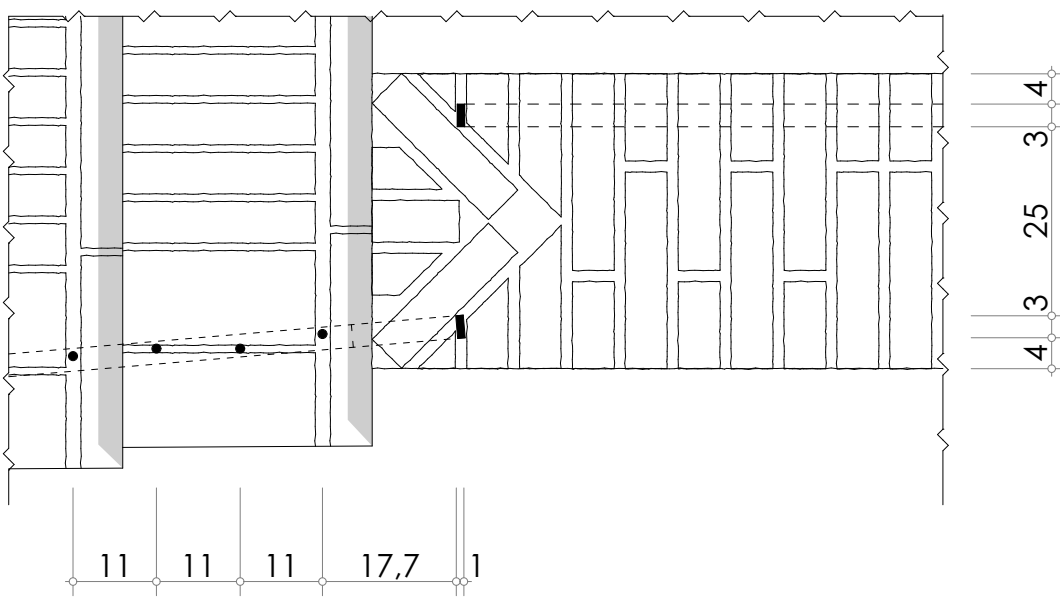
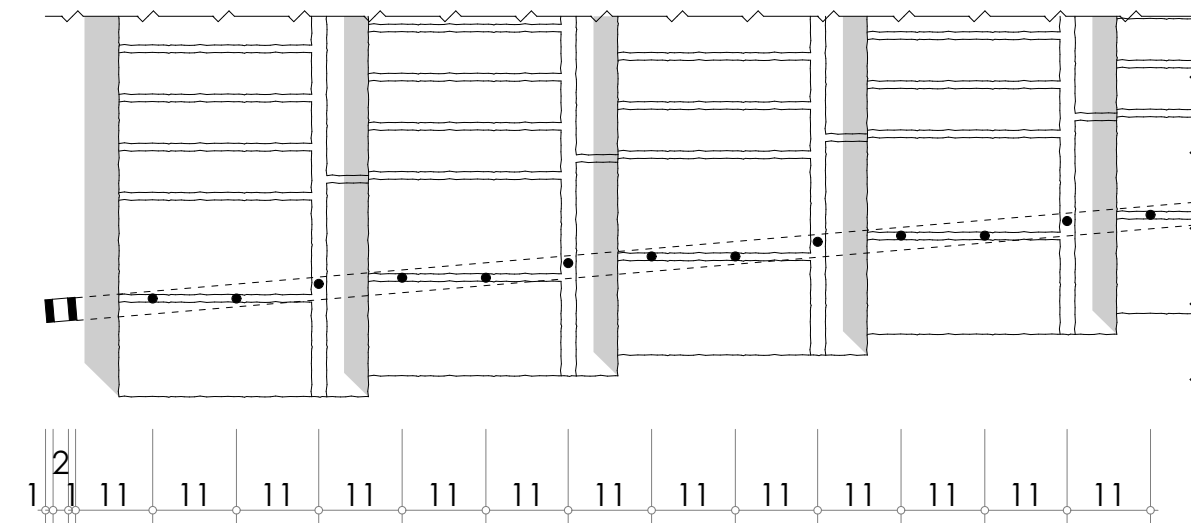

FOTOINSERIMENTO DELLA NUOVA RINGHIERA

PARTICOLARI COSTRUTTIVI DELLA NUOVA RINGHIERA